

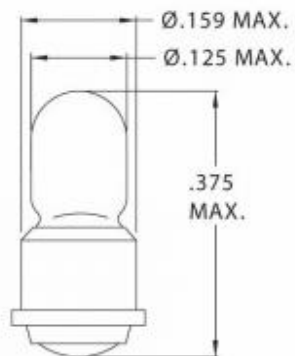

Products

Aviation Incandescent Lamps

CML incandescent lamps offer high performance. Primary advantages include their bright white light output and their relatively low cost.



Part Number: CM682
Serial Number: T-1 SMF
Type: T-1
Base: Sub Midget Flanged
Volts (V): 5
AMP +/- 10%: 0.06
MSCP nom.: .05
Avg life: 60000
Special Features:
Military Reference: M6363/6-1
RoHS Status: Yes

T-1 Wire Terminal (standard)

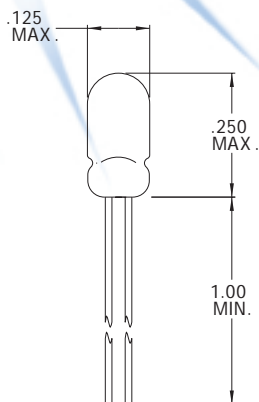

Part Number	Design Voltage	Amps	MSCP	Life Hours	Filament Type
CM6151	5.0	.060	.150	5,000	C-2R
CM6211	5.0	.080	.150	15,000	C-2R
CM7214	5.0	.115	.220	5,000	C-2R
CM7215	5.0	.115	.190	10,000	C-2R
CM7216	5.0	.125	.250	5,000	C-2R
CM8175	5.0	.125	.250	5,000	C-2R
CM8179	5.0	.125	.250	5,000	C-2R
CM8602	5.0	.017	.005	10,000	C-2R
CM8729	5.0	.045	.040	10,000	C-2R
CM7218	10.0	.027	.100	10,000	C-2F
CM7219	12.0	.060	.150	10,000	C-2F
CM23	14.0	.040	.150	16,000	C-2V
CM8111	14.0	.065	.150	10,000	C-2F
CM7220	18.0	.026	.150	10,000	C-2F
CM6838	28.0	.024	.150	4,000	CC-2F

T-1 Sub-Midget Flange Base

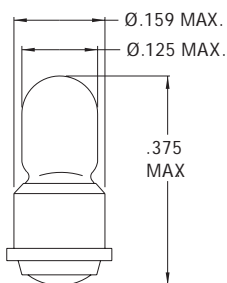

Part Number	Design Voltage	Amps	MSCP	Life Hours	Filament Type
CM7244	1.25	.012	.004	1,000	C-6
CM7245	1.35	.220	.020	25,000	C-2R
CM7226	1.5	.015	.010	5,000	C-2R
CM7227	1.5	.066	.015	100,000	C-2R
CM7228	1.5	.008	.001	10,000	C-2V
CM8102	1.5	.075	.030	16,000	C-2R
CM7246	2.5	.015	.001	10,000	C-2R
CM7247	2.5	.100	.100	10,000	C-2R
CM7248	2.5	.320	.210	5,000	C-2R
CM679	3.0	.013	.001	10,000	C-2R
CM7229	3.0	.016	.020	5,000	C-2R
CM7230	3.0	.025	.020	10,000	C-2R
CM7231	3.0	.060	.030	100,000	C-2R
CM7232	3.0	.120	.130	16,000	C-2R
CM7249	3.0	.008	.001	16,000	C-2R
CM682	5.0	.060	.030	60,000	C-2R
CM685	5.0	.060	.050	25,000	C-2R
CM714	5.0	.075	.090	25,000	C-2R
CM718	5.0	.115	.150	40,000	C-2R
CM6810	5.0	.060	.150	5,000	C-2R
CM7006	5.0	.064	.080	40,000	C-2R
CM7233	5.0	.016	.015	10,000	C-2V